

We Care for Your Needs



ENERGY
INDUSTRIAL COMPANY

We Care for Your Needs

Our History

Energy Industrial Company LLC has been established in Sharjah in 1998. It was affiliated from Energy International Corporation-USA. Since that time, we have been one of the major suppliers of HVAC products, mainly fans, VAV, Control Panels, Silencers, and Sand trap Louvers.

At our facility in Sharjah, we assemble some of our products under licenses from our principals meeting the highest standards.

Our teams are trained and qualified to handle all maintenance work related to our products and to give after sales support to our customers in a very efficient way.

Our design department has the capacity to do custom made jobs and to provide our clients with complete solutions which satisfy their needs.



Our Vision

We commit to provide our customers with our best service. We fully realize that nothing will endure unless it is built upon truth and justice. Therefore; we will not engage in any transaction which does not help all whom it affects.

We believe that our work must be based on honesty and integrity and we also firmly believe in the fundamental importance of the trust among all.

Our aim is to achieve the highest level of development using all our resources and creativity to make our country a better place to live.



ENERGY
INDUSTRIAL COMPANY

PRODUCT HIGHLIGHTS



We Care for Your Needs

Medi-Clean HEPA Filtration System



MCU 900 is a portable, Self-contained (HEPA) filtration system designed to create negative pressure inside any room intended to be converted into an isolation room.

MCU 900 can be used as a clean air re-circulating system in Hospital, Clinics, waiting areas, etc...

MCU 900 is designed to work from a range of 500 to 900 CFM.

MCU 900-UV the germicidal effects of the UV radiation destroy DNA of Bacteria, Viruses, Spores, Fungi, Moulds & Mites avoiding their growth and proliferation.

Fully Adjustable Air Flow

Factory assembled unit with built in speed controller allowing full range control from 500 CFM to 900 CFM

Exhaust Adaptor

Factory assembled unit with built in 8" collar suitable for flexible duct that can be directed to outside through a wall opening or a window. Optional: Flexible duct is optional

Room Air Changes Per Hour

Depending on room size. the high efficiency fan can develop up to 32 ACH, for room size: 5 x 4 x 2.4 m with an airflow equivalent to 900 CFM

Front panel

Includes:

- Power selector knob
- Power indicator lamp
- Run indicator lamp
- Check filter lamp

Applications

- » Negative Pressure Rooms
- » Emergency Rooms
- » Waiting Rooms
- » Intensive Care Units
- » Bronchoscopy Rooms
- » Renal Dialysis Rooms
- » Clinics
- » Nursing Centers
- » Physician Offices
- » Addiction Recovery Centers
- » Correctional Facilities

Easy Maintenance

All components are easily accessible through hinged doors for easy maintenance and service.

Certifications



Model MCU series shown herein are licenced to bear the CE seal. The unit tested & certified according to EN 60335-1:2012 +A11:2014+A13:2017+A1:2019+A2:2019+A14:2019 EN 62233:2008 EN 55014-1:2017 EN IEC 61000-3-2: 2019 EN 61000-3-3: 2013 +A1:2019 EN 55014-2:2015



MCU series are tested for indoor air quality analysis for total Bacterial Count (TBC) - Zero Detected & Total Fungal Count (TFC) - Zero Detected according to sampling method CMMEF Chapter:3 RTL/ENV/SOP:4 by RT laboratory & the units are tested for particle count test confirms to "ISO 1" for particle Count test as per ISO 14644-1 with sampling location at each corners. Total efficiency of unit 99.977% @0.3µ.



Propeller Fans

Model: WMF-Series

- > Static pressure up to 200 Pa
 - > Flow capacity up to 2.7 m³/s
 - > Exhaust or supply in light-duty applications
 - > Available in sizes 200 - 630 mm.
- (For more ranges please consult with factory).



In-Line Tubular Fans

The original idea for the inline duct fans was to combine the benefits of the radial fan, High pressure and low sound level, with the straight-through airflow of the axial fan. The inline radial duct fan with an external rotor motor and straight-through airflow was designed. Apart from high pressure and low sound level, the main benefit was the easy installation.

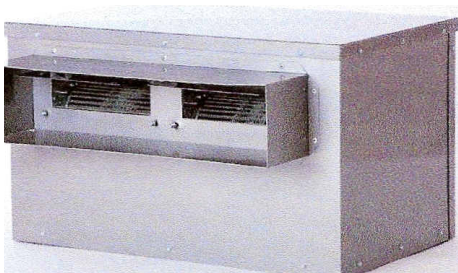

Twin Fans

Energy Industrial twin cabinet Direct & Belt Drive fans are dual unit general purpose ventilation fans. These versatile, quiet air movers provide economical, convenient and effective ventilation. The Twin assembly assures continuous operation. Two similar motors and blowers are used which enable the flexibility of independent or simultaneous operation to achieve double airflow capacity.



Fan Coil Units

Air Flow: 589 ~ 2982cfm
Cooling Capacity: 6.4KW~32.6KW
ESP: 110Pa

(For more ranges please consult with factory).



Control Panel

Control Panels for wide range of applications like Fan Starting Panels with VFD, Auto Change Over, Duty-Sharing, Data Gathering, B.M.S etc

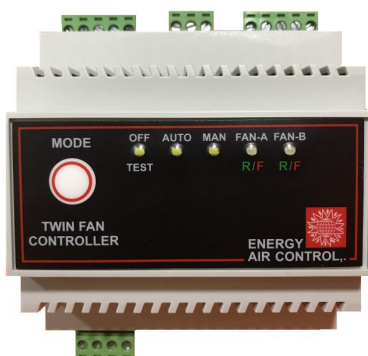

Auto Change over Panel (ACOP)

"ECACOP" is an electronic system designed and developed for automatic operation of twin-fans. Factory wired single unit that can fit on the Fan housing. ECACOP has a silent feature which enables the user to override the auto system (cyclic changeover) to manual mode by pressing the mode button. This feature helps the end user to run any of the selected fans continuously or to do the maintenance in case of failure. The customer has an option to switch on both fans simultaneously, if required, in order to increase the capacity.

Sand Trap Louvers



SERIES STL-A04

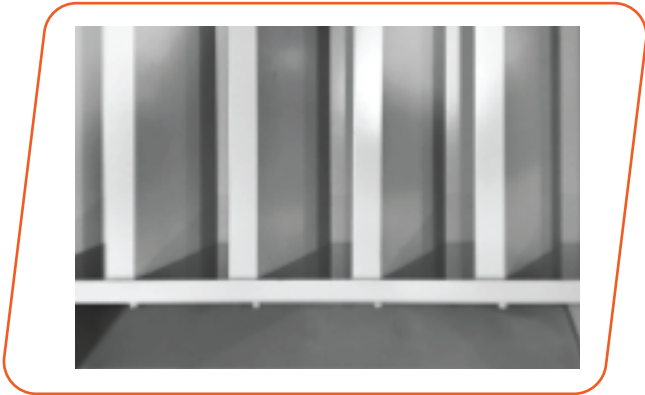

SERIES STLH-A08

	SERIES STL-A04	SERIES STLH-A08
Material	Aluminum Construction	Aluminum Construction
Blades	Vertically-mounted, aerodynamic profiles - 100 mm face	Vertically-mounted, Y-shaped profiles
Core	Fixed	Fixed
Frame	Offset as standard, recessed or flanged as optional	Recessed or flanged as optional
Finish	Mill as standard. Epoxy powder coating as optional	Mill as standard. Epoxy powder coating as optional
Mass/m ² Face Area	17kg	26kg
Free Area	35% (varies per size)	53.6% (varies per size)



AMCA TESTING

Series STL and STLH Sand Trap Louvers have been tested against AMCA 511 Certified Rating Program.

"Energy Industrial Co. certifies that the louvers shown herein is licensed to bear the AMCA Seal. The ratings shown are based on tests and procedures performed in accordance with AMCA Publication 511 and comply with requirements of AMCA Certified Ratings Program. The AMCA Certified Ratings Seal applies to wind driven sand and air performance ratings only."

Odour/Smoke Control

- Kitchen extract odour, smoke and grease control and Air conditioning specialist, Green Energy is a private limited company that offer a diverse range of products and systems across the region:
- The design, manufacture and installation of specialist turnkey solutions for the reduction in smoke, grease and cooking smells from the kitchen extract for restaurant and commercial kitchens.
- Air conditioning schemes suitable for residential, commercial/business applications.
- Supplying both to the trade and direct to the end user, we offer full maintenance and installation back up from experienced engineers. We are a company for whom quality is a basic business principle and we are an BS EN ISO 9001:2008 registered company accredited by TUV, certificate number GB00267.
- Restaurant cooking odour control equipment
- Restaurant grease and smoke control equipment.
- Air conditioning.
- Maintenance on all equipment to maximize efficiency and ensure longevity.
- Our customer base extends to thousands of businesses ranging from small independent organizations to large public limited companies.



ESP



ESP -Auto Washer



UVC-Technology



Ozone Generator



Carbon Media



Odour
Neutraliser .O.N.100

Electrostatic Precipitator

The Electrostatic Precipitator is suitable for the removal of all grease and odour emissions from commercial kitchens.



Any amount of grease and smoke can be eliminated. Green Energy – Purified Air has the complete solution for any kitchen or cooking method. The ESP system is supplemented by a number of other technologies manufactured by Purified Air designed to combat cooking odours, these systems comprise of UV-C, electronic and chemical neutralizing and specially designed media and micro porous filters.

Ultraviolet Odor Control Technology (UV-C)

The emission of cooking odours from commercial kitchens is becoming an increasingly important environmental issue, as well as having a significant influence on the granting of planning permission for new restaurants. UVC Technology from Green Energy uses UV-C (ultra- violet light) to eliminate cooking odours and alter the make up of grease to a better managed compound.



Carbon Filter Solution

These filters are manufactured for ease of installation and incorporation into ducted air systems. They can be used on both supply for purifying incoming air, and can be used on the extract to remove toxic gasses and odours generated within a process.



Autowash System

The Autowash system has been designed as a cost efficient alternative to the manual wash type. The process is designed to operate a daily program to ensure that the electrostatic components remain in a clean and serviceable condition. As the program operates daily not only are there significant savings with maintenance costs but as the components are in a near new condition the performance of the electrostatic filter will always be at optimum. As components become dirty during normal use the filtration efficiency reduces as the dirt on the collectors builds up to form insulation, this affect will be minimized with the Autowash process. It should be noted that the Autowash system will still require some periodical manual maintenance.





Stainless Kitchen Canopies

One Company from Design to Installation



A kitchen ventilation system comprises of a wide range of component parts each requiring a level of specialist knowledge to ensure the end product meets all the necessary criteria.

Why labour yourself with sourcing these various products and juggling multiple sub-contractors and suppliers when one company can manage the entire process for you?

Green Energy - Cantech specialize in the design, manufacture, installation and commissioning of bespoke kitchen ventilation packages tailored to meet the specific needs of any given project.

Our in-house team of specialist engineers can manage the project from the early design stages through to completion, ensuring compliance with all current standards, specifications and regulations.

Company Philosophy of Continual Investment



A company philosophy of continual investment means you can be sure that the most up to date production techniques are utilized.

• Both CNC punch and laser profiling machines ensure the highest possible quality and give the flexibility to provide a rapid response to all customer requirements.

- All canopies are manufactured in strict compliance with DW172. Our unique construction techniques ensure a finish that is free from all visible fixings with all joints silicone sealed on completion to aid on site cleaning.
- All staff are apprentice trained and fully skilled in all aspects of sheet metal fabrication.
- A direct labour force of skilled fitters ensures a smooth installation process through careful coordination with all other trades.

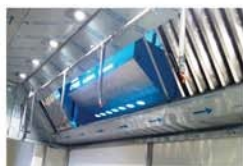

Wide Range of Specialist Services Available



Our wide range of specialist services include:

- Bespoke canopies and associated ventilation systems suitable for both commercial kitchens and food production applications.

Service distribution units supplied as only the outer shell only or as fully

serviced units including all mechanical and electrical services to ease the on-site installation.

- Variety of energy saving solutions including high efficiency canopy LED light fittings as standard, ECanoVent pro-active fan management system and a range of heat recovery options.
- Range of odour control solutions including cold water mist and hot water wash canopies, UV filtration, electrostatic precipitators and carbon filtration systems.
- Gas interlock and proving systems to meet the requirements of BS6173.



WV-GC INDUCTION CANOPY		UV RACK	
<p>WV-GC Eco-Capture canopies are extract & supply models incorporating Eco-Lux high efficiency recessed LED downlight fittings and Airgard baffle type grease filters tested to UL1046 and Din18869-5.</p> <p>Outboard supply air is introduced into the kitchen through a perforated diffuser on the outer face(s) of the canopy and a series of inboard capture jet air ports running along the full length of the canopy introduce a small amount of inboard air at high velocity to entrain the products generated from the cooking process and increase the canopy's containment efficiency.</p> <p>Utilising the latest technology, WV-GC Eco-Capture canopies are manufactured in strict compliance with the BAFES specification for kitchen ventilation systems, DW172.</p> <p>The Canopy is constructed from a minimum 20SWG, 0.9mm type 304 stainless steel with adull polished finish.</p>		<p>The UV lamps are fitted centrally and horizontally in the middle of the canopy with electronic power supply. Ultraviolet hoods use powerful 'UVC' rays to create ozone behind the hood filters-filling the entire hood canopy. The ozone photo-decomposes and oxidizes organic and fat particulates exhausted through the hood.</p>	
<p>PLAN VIEW</p>	<p>SIDE VIEW</p>	<p>Canopy Size: 2750L x 1250W x 650H Final Canopy Extract Volume: - CFM Supply(INBOARD) Volume: - CFM</p>	<p>L.E.D LIGHT DETAIL</p> <p>The H2 Pro is an integrated, fire rated LED downlight. The LED module and driver is built into the fitting. Integrated LED downlights are brighter than conventional GU10 downlights and they last almost twice as long. It is also fully water resistant (IP65) as standard meaning it can be used in areas including kitchens. These lights provide 500LUX at the working surface.</p>
<p>FIXING & MOUNTING DETAILS FOR HOOD TO THE CEILING</p>	<p>Canopy generally to be supported with M10 drop rod secured to the structure and fixed to canopy support rails as indicated opposite. Eyebolts are provided alongside the supports to provide secondary safety wire fixing points to protect against main support failure in the event of an earthquake.</p>	<p>GREASE Baffle FILTER DETAIL</p> <p>The standard fixed blade, non-overloading baffle filter consists of stainless steel outer frame with grease weep holes in the base together with a pair of interlocking fixed blade baffles to create a '3 pass/air-path through the filter cell.</p>	<p>FOR APPROVAL</p> <p>PROJECT: - DESCRIPTION: WV-GC CANOPY</p> <p>DATE: - SCALE: NTS DESIGNED BY: - APPROVED BY: - REFRANING: - EDITOR: -</p>

Kitchen Ventilation



Energy - Twin City Fan is proud to be your single source for commercial and ventilation product solutions. We have evolved with industry to provide full service ventilation product commercial and light industrial customer worldwide. Building on best practices established at our predecessor companies over six decades, We are developing new products, exploring new technology, improving our manufacturing process, streamlining our distribution channels, and enhancing our competitive stance to ensure your satisfaction for decades to come.

BCV

FLAT-BLADED BACKWARD INCLINED UTILITY SETS, BELT DRIVEN

- > 10.5 to 60 inches (270 mm to 1,525 mm) wheel diameters > Airflow to 78,660 CFM (133,600 m³/hour)
- > Static pressure to 8 inches w.g. (1,990 Pa)
- > AMCA licensed for Sound, Air and Fan Efficiency Grade >

Typical Applications: Data Center Exhaust, General HVAC, Elevator Shaft Exhaust/Pressurization, Restroom Exhaust, Stairwell Pressurization, Industrial Ovens, Vehicle Exhaust Generator Room Ventilation, Swimming Pool Exhaust



BSI

SQUARE INLINE CENTRIFUGAL FANS, BELT DRIVEN

- > 8 to 40.25 inches (205 mm to 1,025 mm) wheel diameters > Airflow to 27,400 CFM (46,600 m³/hour)
- > Static pressure to 3.5 inches w.g. (870 Pa)
- > AMCA licensed for Sound, Air and Fan Efficiency Grade
- > UL 705 listed
- > **Typical Applications:** Data Center Exhaust, General HVAC, Generator Room Ventilation, Odor Control, Restroom Exhaust



TCLBR

TUBULAR INLINE RESTAURANT CENTRIFUGAL FANS

UL 762 LISTED FOR THE EXHAUST OF GREASE LADEN AIR

- > 10.5 to 49 inches (270 mm to 1,245 mm) wheel diameters > Airflow to 41,700 CFM (70,800 m³/hour)
- > Static pressure to 4 inches w.g. (990 Pa)
- > AMCA licensed for Sound, Air and Fan Efficiency Grade
- > UL 762 listed for Grease Laden Air
- > **Typical Applications:** Kitchen Exhaust, Dishwasher Exhaust



Ecology Unit Filtration Function:

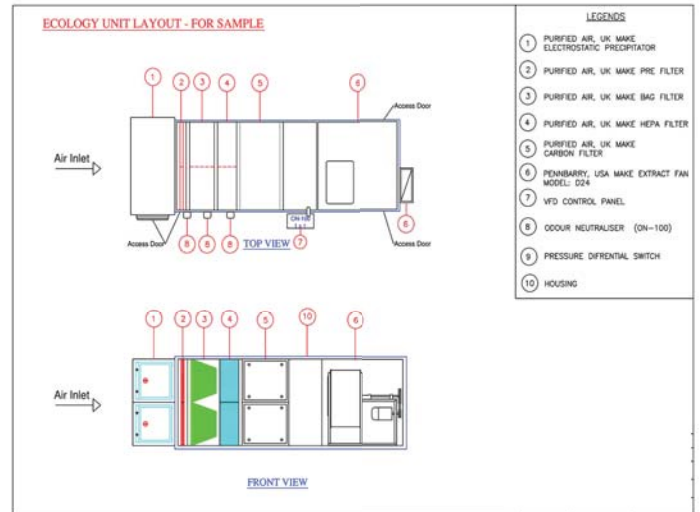

1. Eliminates up to 98% of smoke, oil and grease particles
2. Produces Ozone to help reduce malodours
3. Modular in design
4. Specifically designed for commercial kitchen application
5. Greatly reduces grease build-up within the duct run.
6. Roof/Floor/Inline Mount Utility
7. Class I Heavy-Gauge Galvanized Steel
8. U.L. 762 Rated for Grease Laden Air Exhaust

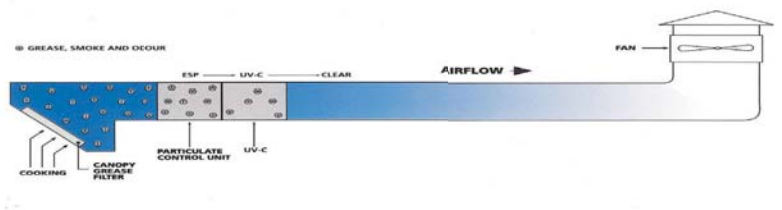
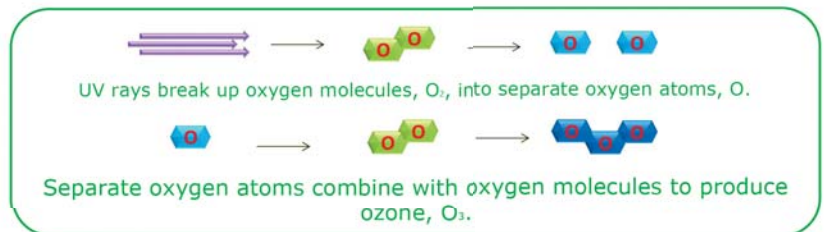

Control System Using ESP and Multi Media Filtration

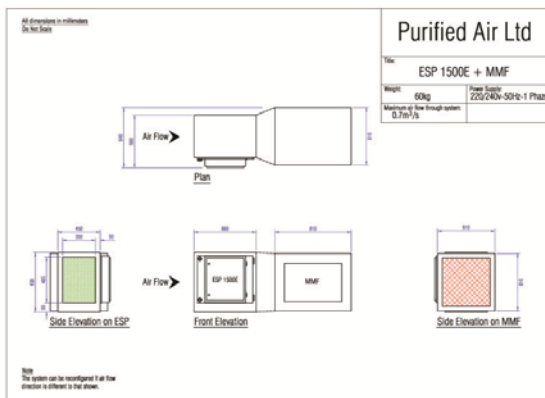

Filter Technology

1. Pre-Filter Eurovent Class 2
2. Ionisation selection
3. Collector section Eurovent Class 9. Filter surface
4. Final filter Eurovent Class 2

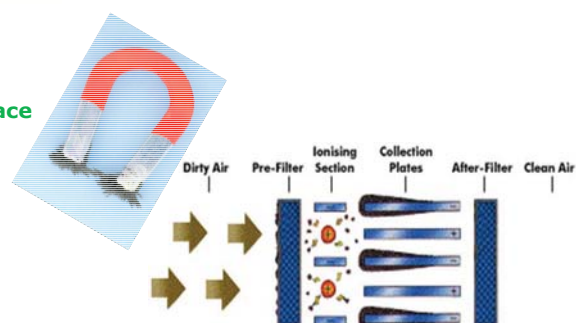



General & Industrial Fans and Ventilation Systems

PRODUCT HIGHLIGHTS

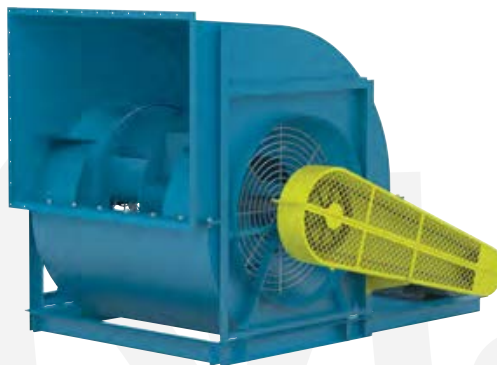

ENERGY
INDUSTRIAL COMPANY

Product Overview

T

CEILING VENTILATOR

- > 17 fan sizes available in horizontal and vertical discharge > Airflow to 1,590 CFM (2,700 m³/hour)
- > Static pressure to 1 inch w.g. (250 Pa)
- > AMCA licensed for Sound and Air > UL 507 listed



DBS

FORWARD CURVED INLINE DUCT BLOWERS

- > 8 to 20 inches (205 mm to 510 mm) wheel diameters > Airflow to 18,500 CFM (31,400 m³/hour)
- > Static pressure to 4 inches w.g. (990 Pa) > AMCA licensed for Sound, Air and Fan Efficiency Grade > UL 705 listed



TCPE

PROPELLER WALL FAN, LIGHT DUTY, EXHAUST, DIRECT DRIVE

- > 8 to 24 inches (205 mm to 610 mm) wheel diameters
- > Airflow to 7,615 CFM (12,900 m³/hour)
- > Static pressure to 0.625 inches w.g. (160 Pa)
- > AMCA licensed for Sound, Air and Fan Efficiency Grade
- > **Typical Applications:** General HVAC, Generator Room Ventilation, Sidewall Exhaust and Supply



WPD

PROPELLER WALL FAN, MEDIUM DUTY, DIRECT DRIVE

- > 14 to 48 inches (355 mm to 1,220 mm) wheel diameters > Airflow to 35,300 CFM (60,000 m³/hour)
- > Static pressure to 1 inch w.g. (250 Pa)
- > AMCA licensed for Sound, Air and Fan Efficiency Grade > UL 705 listed
- > **Typical Applications:** Data Center Exhaust, General HVAC, Generator Room Ventilation, Sidewall Exhaust and Supply



GRV

SPUN ALUMINUM GRAVITY RELIEF & INTAKE VENTILATORS

- > 9 to 48.3 inches (230 mm to 1,230 mm) round throat sizes > Airflow to 25,100 CFM (42,600 m³/hour)
- > Static pressure to 0.375 inches w.g. (90 Pa)



BCRFS

CENTRIFUGAL ROOFTOP FILTERED SUPPLY FAN, BELT DRIVEN

- > 8.86 to 22.05 inches (225 mm to 560 mm) wheel diameters > Airflow to 17,000 CFM (28,900 m³/hour)
- > Static pressure to 4 inches w.g. (990 Pa)
- > AMCA licensed for Sound, Air and Fan Efficiency Grade
- > UL 705 listed
- > **Typical Applications:** General HVAC Supply, Auditorium Supply, Industrial Supply, Kitchen Supply



BSI

SQUARE INLINE CENTRIFUGAL FANS, BELT DRIVEN

- > 8 to 40.25 inches (205 mm to 1,025 mm) wheel diameters > Airflow to 27,400 CFM (46,600 m³/hour)
- > Static pressure to 3.5 inches w.g. (870 Pa)
- > AMCA licensed for Sound, Air and Fan Efficiency Grade
- > UL 705 listed
- > **Typical Applications:** Data Center Exhaust, General HVAC, Generator Room Ventilation, Odor Control, Restroom Exhaust



DCRD

CENTRIFUGAL ROOF EXHAUSTER, DOWNBLAST, DIRECT DRIVE

- > 8 to 19.25 inches (205 mm to 490 mm) wheel diameters > Airflow to 5,020 CFM (8,500 m³/hour)
- > Static pressure to 1 inch w.g. (250 Pa)
- > AMCA licensed for Sound and Air
- > UL 705 listed
- > **Typical Applications:** Data Center Exhaust, General HVAC, General Rooftop Exhaust, Generator Room Ventilation, Jet Bridge Exhaust, Restroom Exhaust

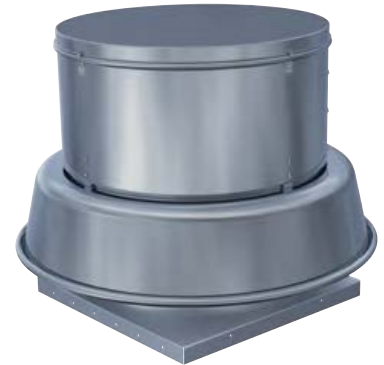

DCRU

CENTRIFUGAL ROOF EXHAUSTER, UPBLAST, DIRECT DRIVE

- > 8.38 to 18.25 inches (215 mm to 465 mm) wheel diameters > Airflow to 3,865 CFM (6,600 m³/hour)
- > Static pressure to 1.5 inches w.g. (370 Pa)
- > AMCA licensed for Sound, Air and Fan Efficiency Grade
- > UL 705 listed
- > **Typical Applications:** General HVAC, General Rooftop Exhaust, Generator Room Ventilation, Jet Bridge Exhaust, Restroom Exhaust



BCV

FLAT-BLADED BACKWARD INCLINED UTILITY SETS, BELT DRIVEN

- > 10.5 to 60 inches (270 mm to 1,525 mm) wheel diameters > Airflow to 78,660 CFM (133,600 m³/hour)
- > Static pressure to 8 inches w.g. (1,990 Pa)
- > AMCA licensed for Sound, Air and Fan Efficiency Grade >
- > **Typical Applications:** Data Center Exhaust, General HVAC, Elevator Shaft Exhaust/Pressurization, Restroom Exhaust, Stairwell Pressurization, Industrial Ovens, Vehicle Exhaust Generator Room Ventilation, Swimming Pool Exhaust



BAF-DW

AIRFOIL WHEEL, DWDI

- > 12.25 to 89 inches (315 mm to 2,265 mm) wheel diameters
- > Airflow to 344,300 CFM (585,000 m³/hour)
- > Static pressure to 14 inches w.g. (3,480 Pa)
- > AMCA licensed for Sound, Air and Fan Efficiency Grade
- > UL 705 listing available
- > **Typical Applications:** Air Handling Units, Exhaust Applications, Explosion-Proof Processes, General HVAC, Green/LEED



TCLB

TUBULAR INLINE CENTRIFUGAL FANS, BELT DRIVEN

- > 10.5 to 49 inches (270 mm to 1,245 mm) wheel diameters > Airflow to 41,700 CFM (70,800 m³/hour)
- > Static pressure to 4 inches w.g. (990 Pa)
- > AMCA licensed for Sound, Air and Fan Efficiency Grade
- > UL 705 listed
- > **Typical Applications:** Data Center Exhaust, General HVAC, Generator Room Ventilation, Odor Control, Waste Water Treatment



TCVX

VANEAXIAL FAN, ADJUSTABLE PITCH BLADES

- > 18 to 84 inches (460 mm to 2,135 mm) wheel diameters
- > Airflow to 233,000 CFM (395,900 m³/hour)
- > Static pressure to 10 inches w.g. (2,490 Pa)
- > AMCA licensed for Sound, Air and Fan Efficiency Grade
- > UL 705 listing available
- > **Typical Applications:** Air Pollution Control, Odor Control, Clean Room HEPA Filtration, Parking Garage Ventilation, Waste Water Treatment



TCLBR

TUBULAR INLINE RESTAURANT CENTRIFUGAL FANS

UL 762 LISTED FOR THE EXHAUST OF GREASE LADEN AIR

- > 10.5 to 49 inches (270 mm to 1,245 mm) wheel diameters > Airflow to 41,700 CFM (70,800 m³/hour)
- > Static pressure to 4 inches w.g. (990 Pa)
- > AMCA licensed for Sound, Air and Fan Efficiency Grade
- > UL 762 listed for Grease Laden Air
- > **Typical Applications:** Kitchen Exhaust, Dishwasher Exhaust



MBO

HEAVY DUTY PRESSURE BLOWER, OPEN RADIAL

- > 19.63 to 58.94 inches (500 mm to 1,500 mm) wheel diameters
- > Airflow to 18,000 CFM (30,600 m³/hour)
- > Static pressure to 170 inches w.g. (42,270 Pa)
- > **Typical Applications:** Air Pollution Control, Dust Collection, Exhaust, Process Cooling, Explosion-Proof Processes, General HVAC, Drying Applications, Vacuum Systems, Material Handling, Pneumatic Conveying, Waste Water Treatment, Process Applications, Combustion Air





Wolter Fan Systems.

Product Overview.



Air in Motion. **Wolter Fans.**

We move **air.**

We **protect.**

General Building Services



AXV / BXV
Axial Flow Fans



ADR / ADQ
Axial Flow Fans with
External Rotor Motor



DKH / DKT
Duct Fans with
Standard Motors

NEW

EKN / DKN
EKNS / DKNS
Duct Fans



RH / RV / RVH / RVS
Roof Fans



KATE / KATD / KAFE / KAFD
Air Extraction Boxes



KB / KBPF
Cabinet Fans



RS / RK
ERM / DRM
Tube Fans



TN / HN
ERSE / DRSD
Centrifugal Fans



ZGF / ZGT
Air Supply Units

Car Park Ventilation & Smoke-extraction



AXV-HT F300 / F400
Smoke-extraction
Axial Flow Fans



RVHT F400
Centrifugal Smoke-extraction
Roof Fan



JFUO / JFRO
JFUC / JFRC
F300 Car Park Jet Fans



JFC
Centrifugal Induction Fans F300
for Car Park Ventilation

NEW



GAES / GADS
GAB / GAPF
Car Park Extraction Fans



JFI
Induction Fans

NEW

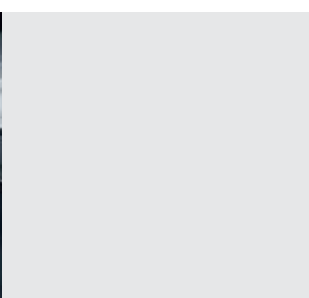

We **develop.**

We **innovate.**

Industrial Applications



CHEM
Chemical-resistant
Centrifugal Fans



Tunnel Ventilation
Jet Fans



TRE / TRZ
HRE / HRZ
Centrifugal Fans for HVAC and
Cooling Tower Applications



Marine Ventilation



Explosion-proof Fans

OEM Solutions



Generator Cooling Fans



Special-purpose fans for drying
applications in food processing
and building materials production



Mobile Ventilation Units



RFE Mixed Flow Fans

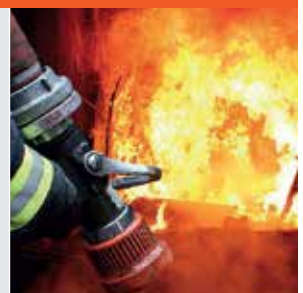

NEW

WolterVA Online Fan Selection

We support.

Visit www.wolter.eu to learn more about our company and product range, find contact details of our local sales agents download comprehensive product information and log on to our online fan selection tool WolterVA.

WolterVA allows you to select each product of our standard range in 5 easy steps. Simply choose the required fan type and input the basic parameters of your duty point. A list of adequate fans matching your duty point then allows you to select a specific fan size according to several technical criteria such as efficiency or noise level. A one page overview data sheet will summarize all relevant data and can subsequently be used for your reference or for a commercial inquiry with us. You can add a number of fan selections to a certain project and save this data for further use.

Thus, WolterVA allows you to easily and efficiently select and price all Wolter equipment required for a specific job.



Energy Industrial Company LLC

P.O. Box 24012

Sharjah, United Arab Emirates

P: 971-6-534-3488

F: 971-6-534-3710

Email: energyco@energyind.ae

www.energyind.ae

METALAIRE™



AIR TERMINAL UNITS

PRODUCT OVERVIEW

**ENERGY
INDUSTRIAL COMPANY**



METALAIRE™

SINGLE DUCT AIR TERMINAL UNITS

Single duct air terminal units are designed to regulate the flow of conditioned air in a distribution system. They are available in a wide range of standard control sequences and work equally well in constant and variable volume systems. Single duct air terminals can be specified with hot water coils, electric heat, sound attenuators, access panels and other optional accessories. They offer a low leakage single blade damper and are available in both pressure dependent and pressure independent applications. Single duct air terminal units are recommended for use in duct systems with a static pressure up to 4" w.g.

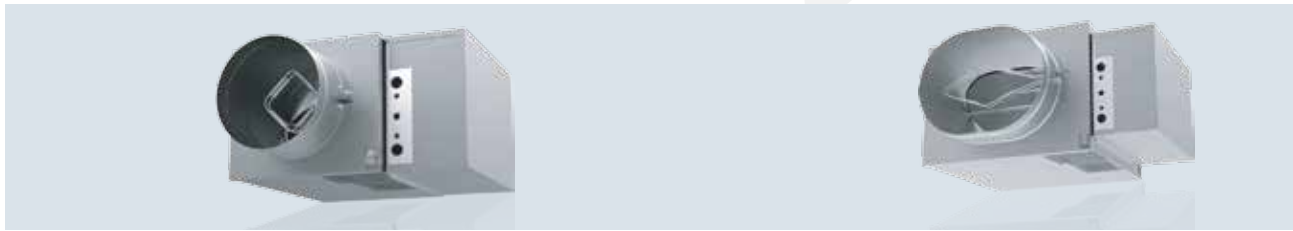

MODEL TH-500

- Available sizes from 4" – 16" round, 20" x 16" rectangular.
- Available ECO option provides ultra-low leakage with high efficiency in sizes 4" – 16". With the ECO option, each unit is manufactured and tested for both casing and damper leakage. An optional certified leakage test label is available.

MODEL TL-500

- Available in sizes 4" – 10" round and 12", 14" and 16" flat oval.
- The maximum height of the TL-500 unit is 12.5".

CONSTANT VOLUME AIR TERMINAL UNITS (SERIES)

Constant volume air terminal units provide cooling through the primary air valve. The primary air valve controls the volume of air that is discharged into the terminal unit. The cooled air is delivered to the space through the terminal's fan. When heating is required the unit provides plenum air that is drawn through the induction inlet. The fan in a constant volume (series) fan powered terminal runs continuously during occupied hours. An optional ECM motor and controls are available on all models.



MODEL FCI-600

- The model FCI-600 fan powered terminal unit is designed to provide superior comfort to zones with both heating and cooling requirements.
- Available in 6 case sizes with a wide range of primary inlet sizes offering the flexibility to meet both capacity and sound requirements.

MODEL FCL-600 LOW PROFILE

- The model FCL-600 low profile fan powered terminal unit is designed to provide superior comfort control in applications with restricted heights. The FCL-600 also can be selected for projects with limited heights in the ceiling plenum.
- Available in 2 case sizes offering the flexibility to meet both your air flow capacity and sound requirements.

MODEL FCQ-700

- The model FCQ-700 has been engineered to provide noise levels that are superior in the industry.
- All case sizes include exclusively tuned inlet and discharge attenuators. The attenuator adds length, not width, providing easier installation and access.
- The unique Energy Saving 4-piece construction allows for fewer seams, reducing leakage. Every unit includes top and bottom rigid access panels, which allows the unit to be flipped upside down eliminating left hand/right hand issues in the field.

VARIABLE VOLUME AIR TERMINAL UNITS (PARALLEL)

The variable volume air terminal units are designed to provide superior comfort control to zones with heating and cooling requirements. The fan in a variable volume (parallel) terminal unit runs only upon requirements for heat. The primary air valve controls the volume of cooled air that is discharged in to the space. In this type of terminal unit, the primary air does not pass through the fan. When heating is required, the terminal provides plenum air that is drawn through the induction inlet.

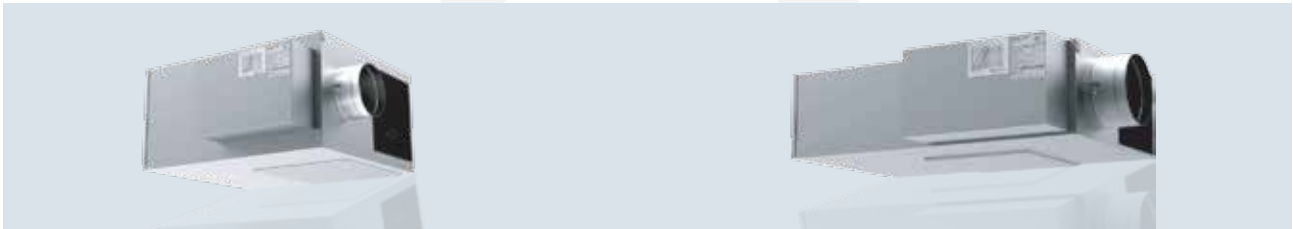

MODEL FVI-500

- The model FVI-500 is available in 7 case sizes with a wide range of primary inlet sizes offering the flexibility to meet both airflow capacity and sound requirements.
- An optional ECM motor and control is available for improved energy efficiency and control.

MODEL FVL-600 LOW PROFILE

- The model FVL-600 low profile air terminal unit is available in 3 case sizes with a wide range of primary inlet sizes offering the flexibility to meet airflow capacity and sound requirements.
- The model FVL-600 also can be selected for projects with limited height ceiling plenums.

DUAL DUCT AIR TERMINAL UNITS

Dual duct air terminal units are designed to regulate the flow of conditioned air in dual duct air distribution systems. In a dual duct system, both heated and cooled air are provided to the terminal and mixed to supply the desired discharge temperature. The dual duct units are available in both pressure dependent and pressure independent applications. They are recommended for use in duct systems with static pressure up to 4" w.g. The units feature a single blade damper in both heating and cooling inlets.

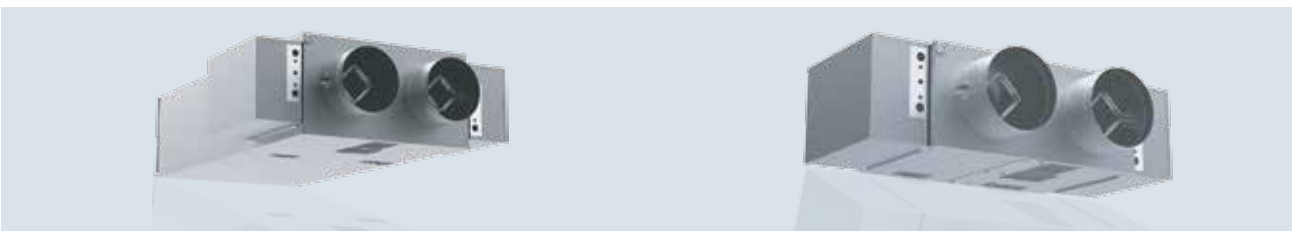

MODEL DH-500

- The model DH-500 high performance dual duct unit has been engineered to provide a 1:30 mixing ration- the highest in the industry.
- Available in 4" – 16" round inlet sizes.

MODEL DD-500

- The model DD-500 was designed for both heated and cooled air to be provided to the terminal and mixed in downstream duct work (by others) to provide the desired discharge temperature.
- Available in 4" – 16" round inlet sizes.

BYPASS AIR TERMINAL UNIT

MODEL BP-500

- The model BP-500 bypass air terminal units are designed to achieve VAV delivery of conditioned air to a room in single duct, constant volume air distribution systems.
- The model BP-500 uses a primary air damper working in concert with a bypass port damper.



METALAIRE™

RETROFIT AIR TERMINAL UNITS



MODEL SR-500

- The model SR-500 is a retrofit terminal designed to fit existing low pressure/low velocity square or rectangular duct systems. They can also be used in dust systems with static pressure up to 4" w.g.

MODEL RA-500

- The model RA-500 retrofit assembly is customized to slip into existing mechanically regulated single or dual duct terminals to convert existing constant volume operation.
- RA assemblies are currently available to fit most of the competitive terminals manufactured from the 1960s to the 1980 s. In most applications, units are installed by removing existing volume regulators and inserting the RA valve without disrupting existing ductwork.

MODEL RT-500

- The model RT-500 is designed to regulate the flow of conditioned air in single or dual duct air distribution systems and is also used to provide positive or negative pressures in laboratory hood applications. The model RT-500 is primarily used to convert mechanically regulated constant volume single or dual duct air terminals to more efficient variable volume air terminals without disrupting total system operation.
- The RT-500 is easily installed into existing ductwork in front of an existing air terminal.

FACTORY PROVIDED CONTROLS

Metalaire's air terminal units are available with a wide range of control options and accessories to meet your design requirements. We can provide pneumatic, electric, analog electronic, factory provided DDC controls or DDC (by others) factory mounted.



FACTORY PROVIDED DDC CONTROLS

- Metalaire offers both LONMARK and BACnet ready DDC controls shipped to your project, addressed and ready to install within the shortest standard lead times in the industry.
- A wide range of room sensors, cabling and laptop connection hardware is also available.



Energy Industrial Company LLC

P.O. Box 24012
Sharjah, United Arab Emirates

P: 971-6-534-3488

F: 971-6-534-3710

Email: energyco@energyind.ae

www.energyind.ae



Powered Aire Inc.



PRODUCT OVERVIEW

COMMERCIAL

INDUSTRIAL

SPECIALTY

AIR CURTAINS

ENERGY
INDUSTRIAL COMPANY



SERVING THE AIR CURTAIN INDUSTRY SINCE 1997

CED/CHS

Customer Entrance Air Curtain



Designed for high traffic customer and personal doors with openings up to 11 feet high.

- CED curtains available in unheated or electric heat
- CHD curtains available in hot water or steam
- CED nozzle widths from 36" to 145"
- CHD nozzle widths from 45" to 174"
- 0.5 hp dual speed motors
- 304 stainless steel case

CAMELEON

Flush Mounted Air Curtain



One piece unit installs above the ceiling

- CLD Model (.5 hp motors) for customer entrances up to 11 feet high
- CHD (.75 hp motors) for customer entrances up to 14 feet high
- Nozzle widths from 36" to 144"
- High and low speeds
- Hinged grille for easy filter access
- Unheated or heated
- No ducting required
- White grill standard – additional metals and colors available



Stainless steel grill shown above. Grill drops down for easy cleaning and maintenance.

MP

Low Profile Air Curtain



For use where headroom is limited for openings up to 10 feet high

- Only 8.5" high and 13.5" wide
- Nozzle widths from 29" to 117"
- Unheated and electric heat
- Hot water or steam available
- Variable speed and dual speed models available

Unique Plenum Design

Models CED, BCE, BCT, ETD, RBT

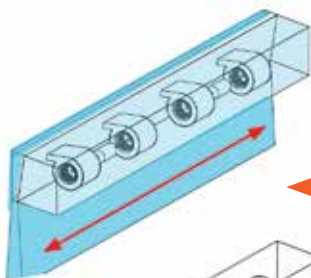

Powered Aire aims the air from the blowers towards the back of the air curtain where it fills a plenum and is forced out evenly across the width and length of the air curtain.

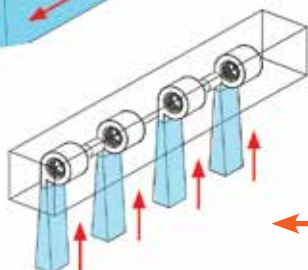

Other air curtain manufacturers aim the discharge of each blower down resulting in dead spots wherever there are spaces between blowers.

MB 123 Fast Mount

Models CED, BCE, BCT, ETD, RBT

Wall bracket attaches to wall



Top mounting bracket attaches to back of air curtain

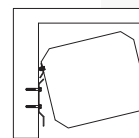

Air curtain is placed over bottom bracket and locks in place

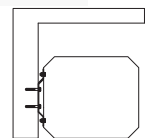

The MB 123 consists of a plate with a universal hole pattern that is attached to the wall and a bar that is attached to the air curtain. The back side of our commercial air curtains have four standard mounting holes. The MB 123 can be used when the holes do not line up with wall studs or other structural supports. With the mounting option, the weight of the unit does not have to be supported while the lags are being installed.

BCE/BCT

Bug Control Air Curtains



Model BCE Bug Control Air Curtain

Ideally suited for delivery doors to kitchens, food prep and storage areas

- For openings up to 8 feet high
- Nozzle widths from 36" to 145"
- Single speed
- Can be ETL listed for indoor or outdoor use



USDA Compliance

FDA Compliance

AIB Compliance

Model BCT Bug Control Air Curtain

Ideally suited for delivery doors to kitchens, food prep and storage areas

- For openings up to 10 feet high
- Nozzle widths from 36" to 145"
- Single speed
- Can be ETL listed for indoor or outdoor use

ETD/THS

Climate Control Air Curtains



ETD



THS

Designed for dock and ground level doors with openings up to 12 feet high

- High-efficiency discharge plenum
- Unheated or electric heat
- 1.75 to 4.75 hp dual speed motors
- Hot water and steam available
- Fully assembled and factory tested

RBT

ETL Sanitation Certified Air Curtain



The RBT is the restaurant industries go-to insect control air curtain. Recommended up to 7 ft. high

- 304 stainless steel case
- 0.75 hp TEAO single speed motor(s)
- High-efficiency discharge plenum
- Fully assembled and factory tested
- ETL listed for indoor/outdoor use
- ETL Sanitation Certified to NSF Standard 37
- USDA & FDA compliant



USDA Compliance

FDA Compliance

AIB Compliance

RMP

Restaurant Mini-Power Air Curtain



The RMP is a low-profile, single-speed air curtain designed for insect control. It's durable stainless steel case combined with a compact design makes it ideal for restaurant and concession stand use where mounting space is limited. Recommended up to 7 ft. high

- 304 stainless steel case
- 0.5 hp motor(s)
- High-efficiency discharge plenum
- Fully assembled and factory tested
- ETL listed for indoor/outdoor use
- ETL Sanitation Certified to NSF Standard 37
- USDA & FDA compliant



Energy International Corporation Represents Powered Aire Products in the Middle East

TSD

Industrial Air Curtains

Designed for use on dock doors and other large openings in industrial settings with openings up to 17 feet high.

- Direct drive – no belts
- Motor/blower plate is one removable assembly
- TEAO motors and galvanized blower wheels mount directly to 1-inch shaft
- Non-corrosive 304 stainless steel casing for long lasting performance
- Top and bottom access panels allow for easy inspection, cleaning or servicing
- Unheated, hot water, steam, indirect gas fired and direct gas fired available
- Powered Aire offers AMCA licensed unheated TSD air curtains in widths up to 30 feet



EHD

Extra High Door Air Curtains



The EHD maintains environmental separation for extra-high industrial doors.

- For openings up to 22 feet high
- 304 stainless steel construction
- Unheated, hot water, steam, indirect gas fired and direct gas fired available
- Nozzle widths from 4 to 20 feet
- 5 hp TEAO direct drive motor(s)



BPA

Big Powered Air Curtains



The BPA provides environmental separation for the biggest industrial openings including hangar doors and train bay doors.

- For openings up to 30 feet high
- 304 stainless steel construction
- Nozzle widths from 5 to 20 feet
- 7.5 hp TEAO direct drive motor(s)



**ENERGY
INDUSTRIAL COMPANY**



Energy Industrial Company LLC

P.O. Box 24012

Sharjah, United Arab Emirates

P: 971-6-534-3488

F: 971-6-534-3710

Email: energyco@energyind.ae

www.energyind.ae

THE LEADING EDGE IN Smoke & Fire Curtains

- Automatic Smoke Curtains
- Automatic Fire Curtains
- Static Smoke & Fire Curtains
- Ventilation



 **BLE** Smoke & Fire
Curtains
MAKING BUILDINGS SAFER

ENERGY
INDUSTRIAL COMPANY

BLE - SMOKE & FIRE CURTAIN PRODUCT OVERVIEW



SC1 (SC60)

FEATURES

Active smoke curtain barrier incorporating X32k fabric.

- 120 minute integrity (E) up to 600°C.
- Excellent compartmentation properties.
- Smoke sealing available.
- Multiple control options.
- Overlapped curtains for large widths.
- Oversized drops available.
- Faceted curtains for curves possible.



SC2 (D120)

Also designated as: Draft Curtains, Static Barriers and Fixed Curtains.

FEATURES

Static draft curtain incorporating X32k fabric

- Time / temperature classification D120 to provide smoke control in industrial and commercial locations.
- 120 minute integrity (E) up to 600°C.
- Unlimited width and drop.
- Manufactured to suit almost any shape and size.
- Pocket hem for conduit to increase rigidity.
- Bespoke fixing methods available to suit most requirements.



FC1 (FC60)

FEATURES

- 60 minute fire integrity curtain incorporating X32k fabric.
- 60 minute integrity up to 1000°C.
- Multiple control options.
- Provision of fire compartments and refuges.
- Excellent replacement for fire doors.



FC2 (FC240)

FEATURES

240 minute fire integrity curtain incorporating C41000WK fabric.

- 240 minute integrity up to 1000°C (E).
- Provision of "Insulating Zone" for means of escape requirements.
- Increased resistance to the irradiance of heat (W).
- Compliance with impact resistance standards.
- Multiple control options.
- Provision of fire compartments and refuges.
- Excellent replacement for fire doors.
- Provision of a protected means of escape.





FC3 (EWBI)

FEATURES

- 240 minute fire integrity curtain incorporating EW-BI fabric.
- 240 minute integrity up to 1000°C (E).
- 90 minutes of irradiance heat flux protection (W).
- Compact installation for high performance.
- Multiple control options.
- Provision of fire compartments and refuges.
- Excellent replacement for fire doors.
- Provision of a protected means of escape.



FC4 (V4A)

FEATURES

- 120 minute fire integrity curtain incorporating V4A fabric.
- 120 minute integrity up to 1000°C (E).
- 120 minutes of irradiance heat flux protection (W).
- Compact installation for high performance.
- Multiple control options.
- Provision of fire compartments and refuges.
- Excellent replacement for fire doors.
- Provision of a protected means of escape.



AC1 (SD240A)

Also designated as:- Accordion Curtains.

FEATURES

- 180 minute fire integrity curtain (both corner and lateral) incorporating C41000WK fabric
- 180 minute integrity up to 1000°C in masonry.
- 120 minute integrity up to 1000°C in gypsum.
- Eliminates the use of corner posts / columns.
- Provision of fire compartmentation and refuges.
- Multiple control systems.



HC1 (Horizontal)

Also designated as:- Horizontal Curtains.

FEATURES

- 180 minutes fire integrity curtain incorporating C41000WK fabric.
- 180 minutes integrity up to 1000°C (E).
- 20 minutes of irradiance heat flux protection (W).
- Provides horizontal closure for stairwells and skylights.
- Provision for the use of a dual power supply.





Why Choose BLE Smoke & Fire Curtains?

BLE designs, manufactures and installs gravity failsafe smoke and fire curtains that offer the latest in electronic technology and innovation, making their products the prime choice with designers, architects and engineers.

BLE products are designed to be discreet, robust and simple to operate and maintain. Energy international and BLE will work with clients to find a solution to meet the most challenging architectural requirements. This is why BLE smoke & fire curtains feature in prestigious refurbishments and ground breaking new buildings throughout the Middle east across the globe.

BLE gravity fail-safe curtains have a high level of technical specification and incorporate features that integrate within building management systems, yet offer a cost effective and flexible solution to smoke and fire control.

The BLE manufacturing processes and quality control procedures are certified to meet the requirements of BS EN ISO 9001:2008.

Every smoke and fire curtain from BLE is rigorously tested to a range of BS, EN and UL standards allowing their incorporation in designs worldwide.



Energy Industrial Company LLC

P.O. Box 24012

Sharjah, United Arab Emirates

P: 971-6-534-3488

F: 971-6-534-3710

Email: energyco@energyind.ae

www.energyind.ae

We Care for Your Needs

Our Success Stories

Over the years, Energy Industrial company has played an important role in the creation of international airports, trade centers, shopping malls, gas refineries, hospitals, hotels, schools and factories, many throughout the Middle East, requiring around-the-clock operation in adverse condition. The following are a sampling of the thousands of projects EIC has been involved in. To see a complete list, visit www.energyintl.com.



 **SPARKLE TOWER**
Dubai, United Arab Emirates



 **AIRPORT EXPANSION**
Abu Dhabi, Dubai, Sharjah, UAE



 **YAS MALL**
Abu Dhabi, United Arab Emirates



 **SHAMS GATE**
Abu Dhabi, United Arab Emirates



 **AL WAKRA HOSPITAL**
Al Wakra, Qatar



 **NEW DOHA INTERNATIONAL AIRPORT** - Doha, Qatar



 **KING ABDULLAH FINANCIAL DISTRICT** - Al Wakra, Qatar



 **KING ABDULAZIZ CENTER FOR WORLD CULTURE** - Riyadh, KSA



 **HARAMAIN HIGH SPEED RAIL STATION** - Jeddah, Saudi Arabia



 **ABRAJ AL BAIT**
Makkah, Saudi Arabia



 **GALLERIA MALL**
Amman, Jordan



 **QUEEN ALIA INTERNATIONAL AIRPORT** - Amman, Jordan

We Care for Your Needs



ENERGY
INDUSTRIAL COMPANY



Energy Industrial Company LLC

PO Box 24021 Sharjah, United Arab Emirates

Tel: +971 6 534 3488, Fax: +971 6 534 3710

Email: energyco@energyind.ae, www.energyintl.com